

Look & Feel

These doors come in Black and Satin finish. Our sliding door also comes with 2-4 stops. This ensures that the door slides quietly and closes softly, on 2-4 classic or modern wheels.

Black or Steel

All Hardware comes with a black powder coated finish or a stainless steel satin finish. This ensures it lasts as long as you need it to.

Specifications

- Fits door thickness 1-3/8" to 1-3/4"
- 2 to 4 Classic straps and wheels
- Track length 78-3/4" or 78-3/4" x 2 for the bypass opening slider
- Material: Knotty Pine / -Door Height: 84"
- Door Width: 37" / -Door Thickness: 1-3/8"
- Number of Panels: 1 / -Panel Type: Flat
- Weight: 24 lbs / -Color/Finish: Ready to Finish

Knotty Pine Wood Barn Door

The Lily Ann knotty pine door is a great addition to any modern or traditional home. The wood is unfinished and ready to be stained or painted to desired finish. Two doors can be installed side by side for larger openings.



Visit us @our website

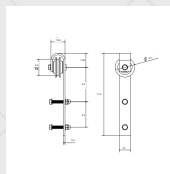
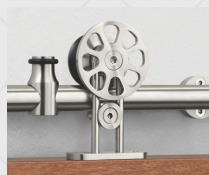
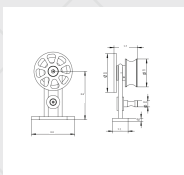

Satin or Black Finish



Powder Coated Hardware



Ready to be Stained or Painted

